

INSTRUCTIONS FOR N-CVRESC TRIM FOR N-98CVR / N-77CVR SERIES EXIT DEVICE

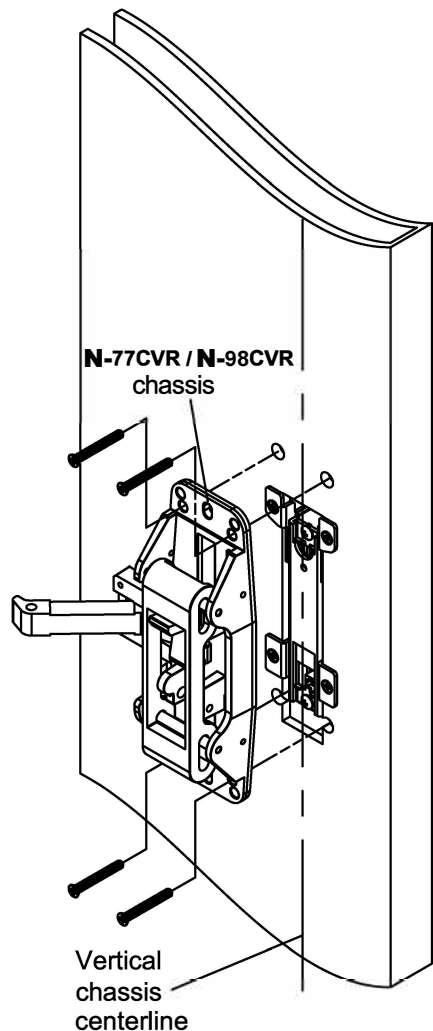
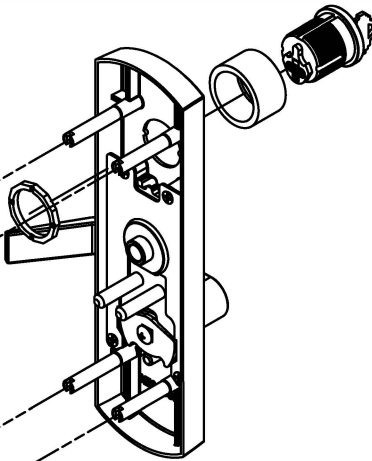
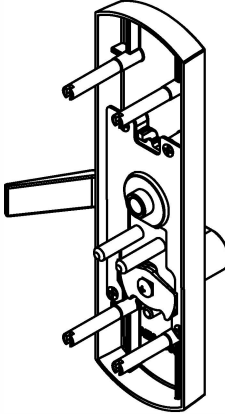
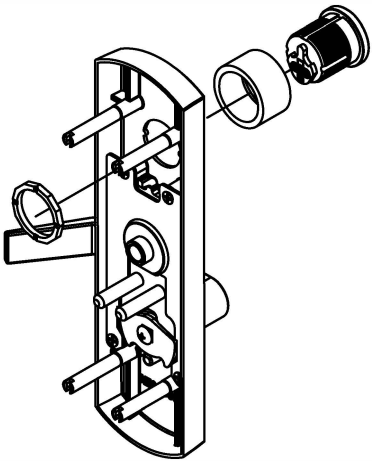
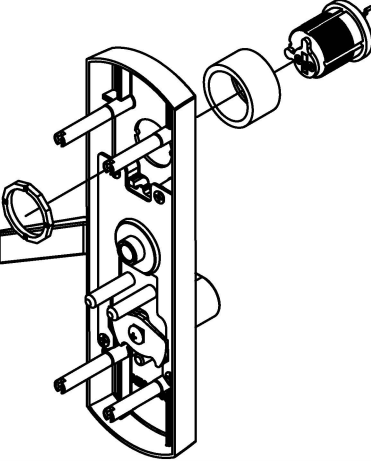

N-CVRESC-00	N-CVRESC-30	N-CVRESC-40	N-CVRESC-05
 <p>Lockable Nesc Lever Trim Key locks & Unlocks Lever</p>	 <p>No Cylinder Trim Always Operable</p>	 <p>Pull when Push bar locked down Dummy Nesc Lever Trim</p>	 <p>Key unlock Nesc Lever, Key remained on Cylinder unless Locked. Cylinder Nesc Lever Trim</p>
<p>13 function Entrance</p>	<p>15 function Passage</p>	<p>10 function Dummy</p>	<p>04 function Storeroom</p>
<p>Attach the collar and mortise cylinder to the nesc case with mortise nut, attach case to door thru bolting (4) screws to the chassis, aligning spindle to hub.</p>	<p>Attach nesc case to door thru bolting the (4) screws to the chassis, allaning spindle to hub of the chassis.</p>	<p>Attach the collar and dummy cylinder to the nesc case with mortise nut, attach case to door thru bolting (4) screws to the chassis.</p>	<p>Attach the collar and mortise cylinder to the nesc case with mortise nut, attach case to door thru bolting (4) screws to the chassis, aligning sprindile to hub.</p>

N-CVRESC Lever Trim For N-77CVR / N-98CVR Series

Method of Changing Hand of Lever LHR(Reverse Step for RHR)

1.Rotate lever to LHR positioned at 90°.

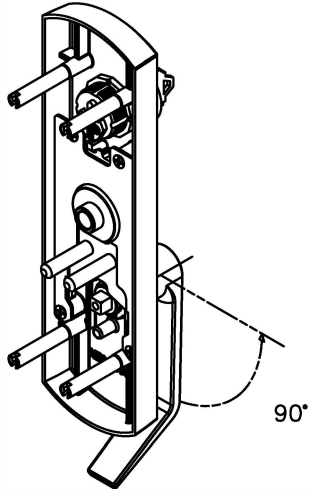

2.Place and fasten cam piece with locked type washer and screw.

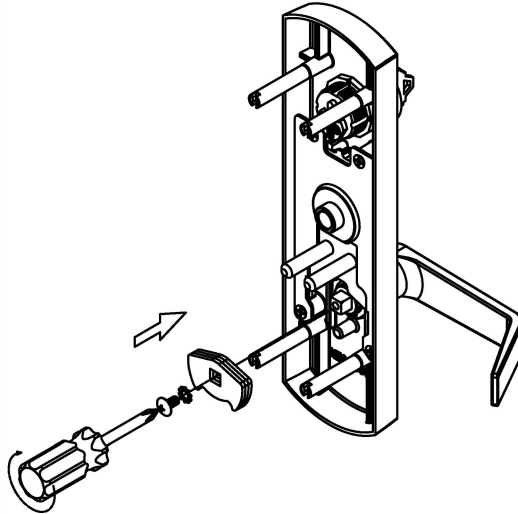

3.Done.

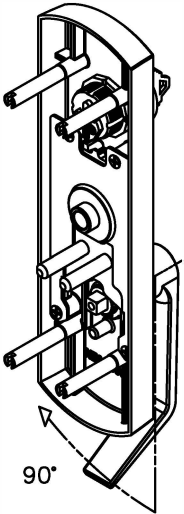
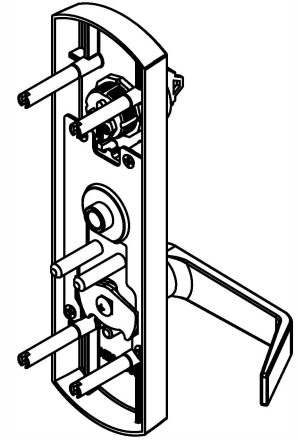

1.Rotate lever to RHR positioned at 90°.

2.Place and fasten cam piece with locked type washer and screw.

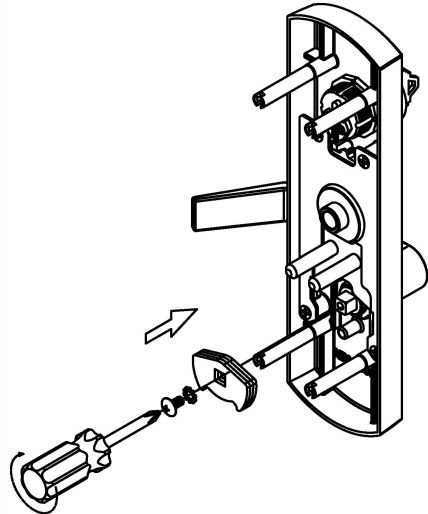

3.Done.

